

# Scottish National Portrait Gallery

## Sensory Map

### Level 2

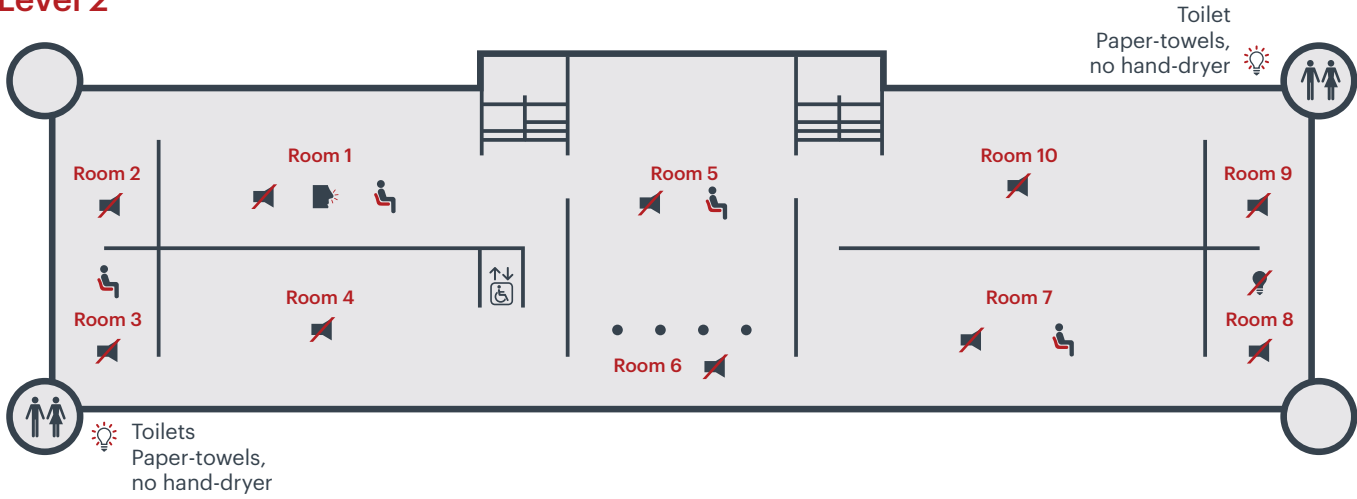

### Level 1

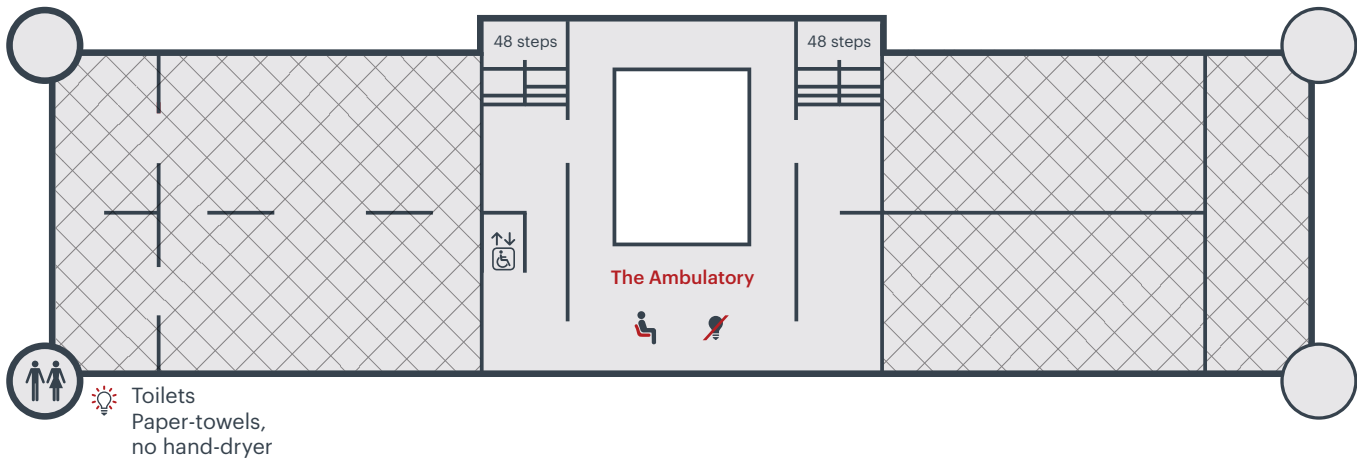

### Ground Level



### Key

|                   |               |
|-------------------|---------------|
| Information Desk  | Bright lights |
| Female Toilet     | Low light     |
| Male Toilet       | Loud area     |
| Accessible Toilet | Quiet area    |
| Baby Changing     | Strong smells |
| Accessible Lift   | Seats         |
| Lockers           |               |

The galleries tend to be quieter first thing in the morning.

The Library is a quiet space with chairs with armrests that swivel and a table that you can sit at. You can come here at anytime during your visit.

There is seating in most of the rooms and portable stools that are available to pick up near the gallery entrances.

The exhibitions change regularly, please speak to one of our Gallery Attendants if you have any concerns or queries - we're here to help.