

Scottish National Gallery of Modern Art - Modern One Sensory Map

LEVEL 2

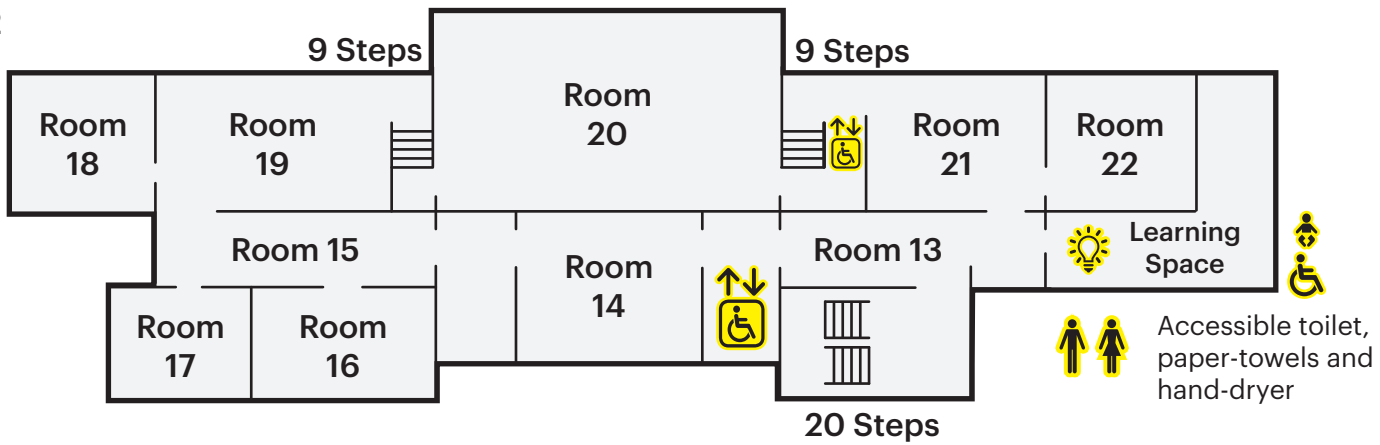

LEVEL 1

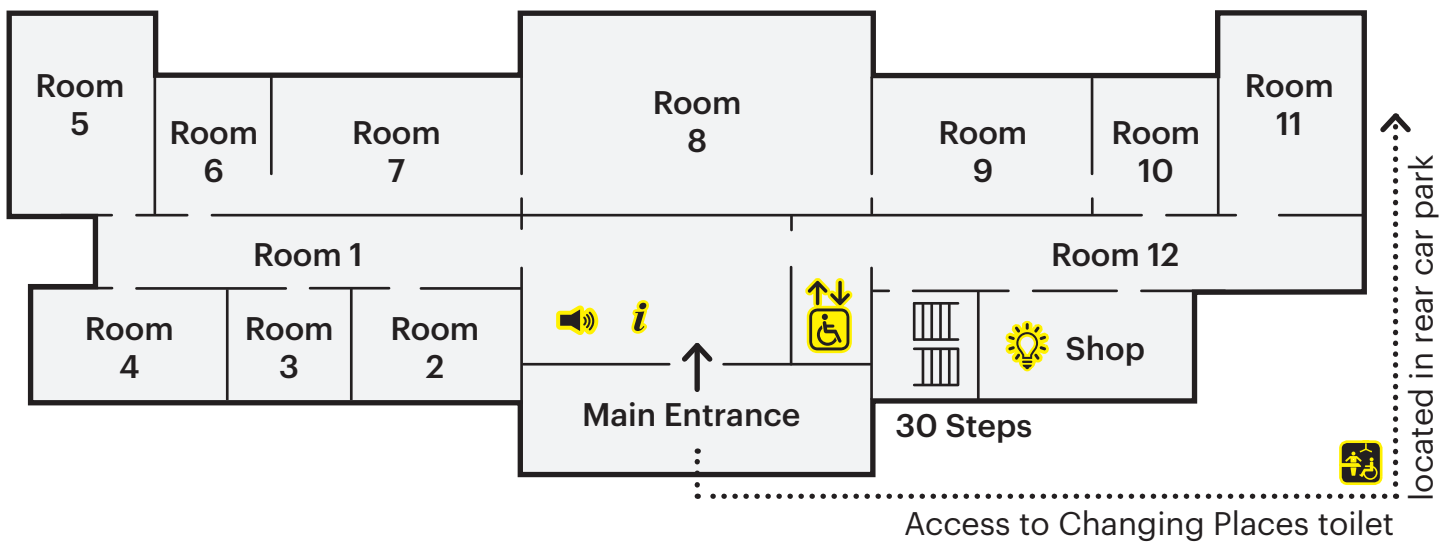

LEVEL 0

Alternate access through cafe to Changing Places toilet located in rear car park

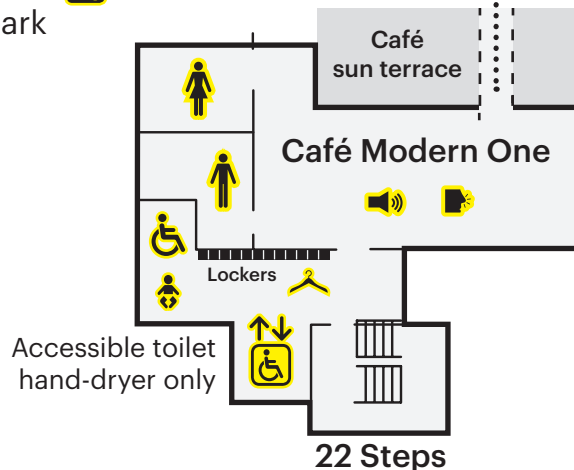
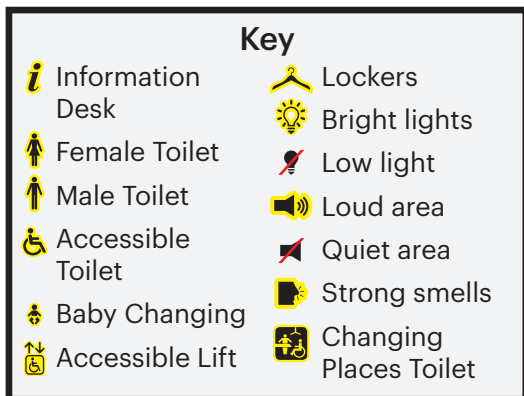

The gallery tends to be quieter first thing in the morning.

Exhibitions change regularly, visit our website to see what's on.

Accessible parking is at the front and rear of the building, spaces at the rear are next to the Changing Places toilet.

Ask a member of staff if you need a quiet space, or you are welcome to use the sculpture park. There's seating and portable stools available throughout the gallery.

Please speak to a gallery attendant if you have a query, we are here to help.